

May also be used with CT and VT rated inverters when specified in the MICROMASTER Catalog DA51.2.

CT ✓	VT ✓
Catalog DA51.2	

May also be used with inverters when specified in the SINAMICS Catalog D11.1.

HO ✓	LO ✓
Catalog D11.1	

Choke Identification		Electrical Characteristics			Weight	Overall Dimensions (mm)						Fixing Dimensions (mm)						Terminals	Cable Cross Section				
MFLB	Frame Size (FS)	Voltage	Current	Phase	Choke kg	Choke			Choke + Inverter			Inverter			Output Choke			Tightening Torque		min		max	
						A	B	C	D	E	F	G	H	Fixing Size	I	J	Fixing Size	Nm	lbf.in	mm ²	AWG	mm ²	AWG
6SE6400-3TC00-4AD3	A	200 - 240	4.0	3	1.3	200	75.5	50	200	75.5	199	-	160	M4 (2)	56	187	M4 (4)	1.1	10	1	17	2.5	14
6SE6400-3TC00-4AD2	A	380 - 480	4.0	3	1.9	200	75.5	110	200	75.5	259	-	160	M4 (2)	56	187	M4 (4)	1.1	10	1	17	2.5	14
6SE6400-3TC01-0BD3	B	200 - 480	10.4	3	4.1	213	150	80	213	150	252	138	174	M4 (4)	120	200	M4 (4)	1.5	13.3	1.5	16	6	10
6SE6400-3TC03-2CD3	C	200 - 480	26	3	6.6	245	185	80	245	185	275	174	204	M5 (4)	156	232	M5 (4)	2.25	20	2.5	14	10	8
6SE6400-3TC01-8CE3	C	200 - 600	22	3	10.8	245	185	110	245	185	305	174	204	M5 (4)	156	232	M5 (4)	2.25	20	2.5	14	10	8

CAUTION

Operation is only permissible with a pulse frequency of **4 kHz**. Make shure that the automatic pulse frequency reductions are disabled.
Mandatory required parameter adjusting: P1800 = 4 kHz, P0290 = 0 or 1

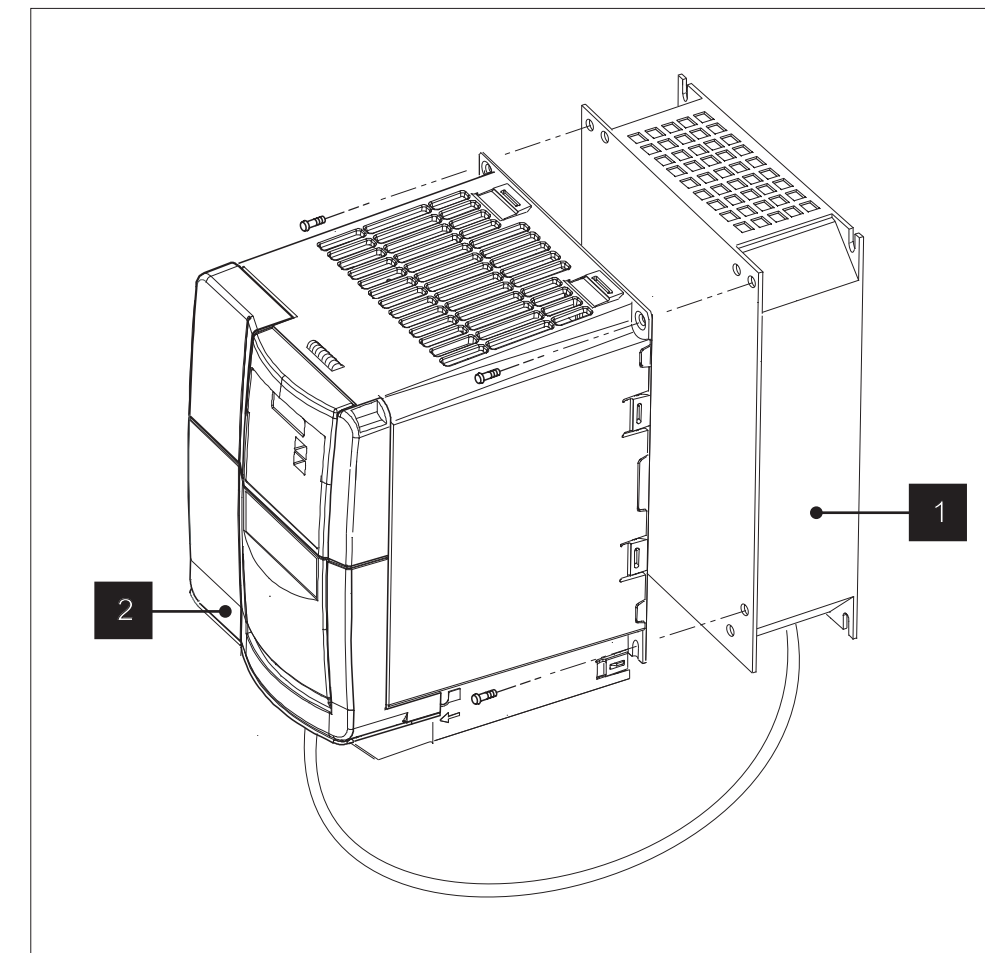

OPTIONS COMBINATIONS EXAMPLES

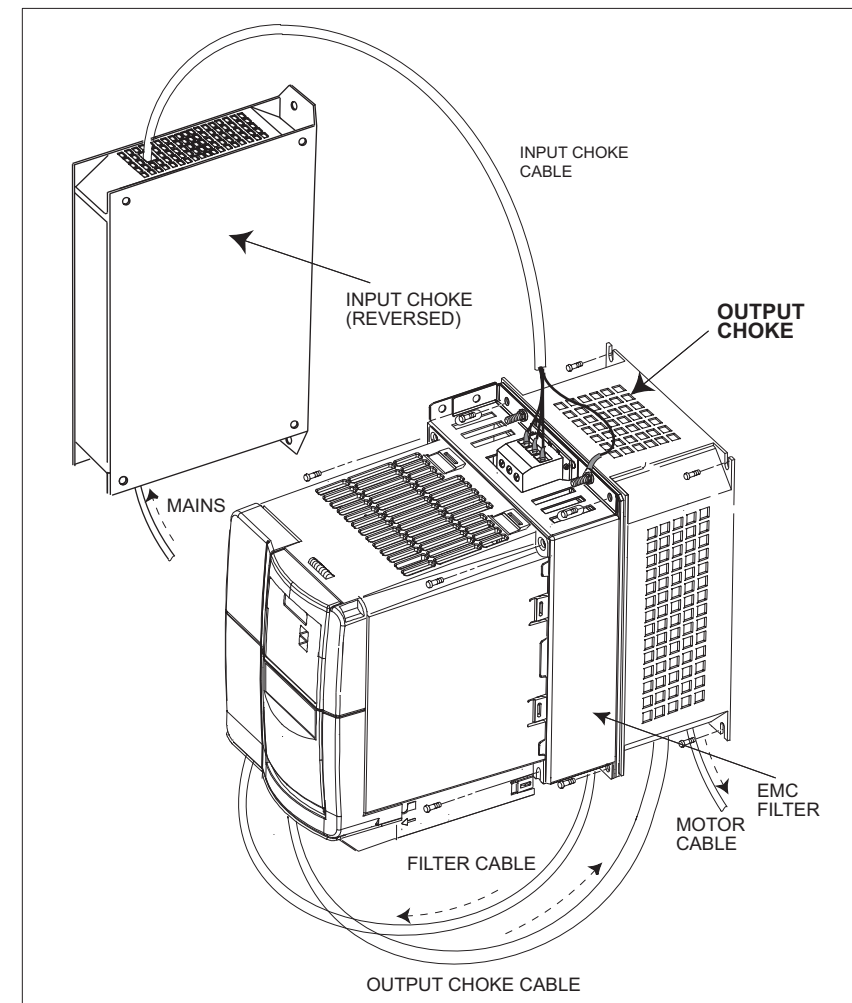
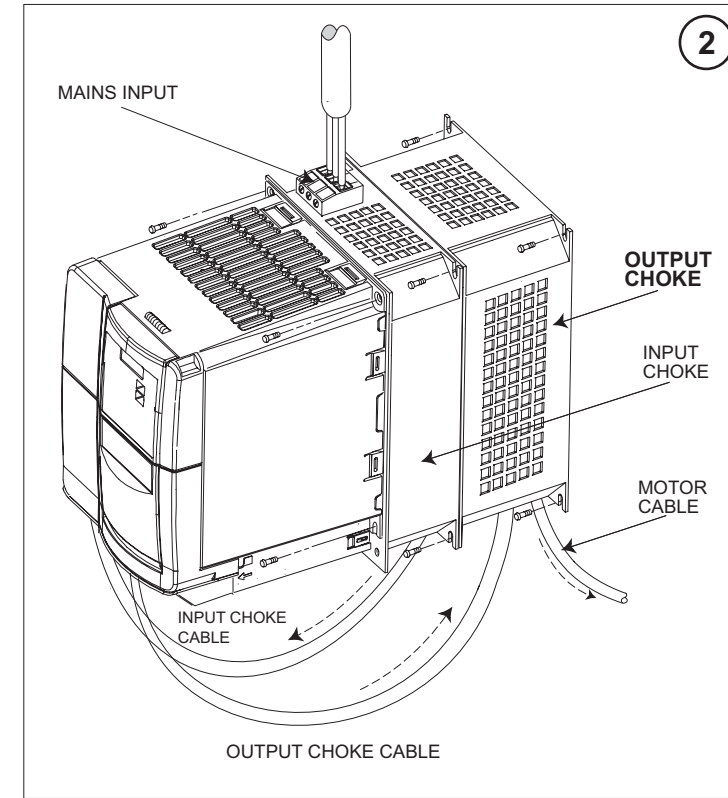
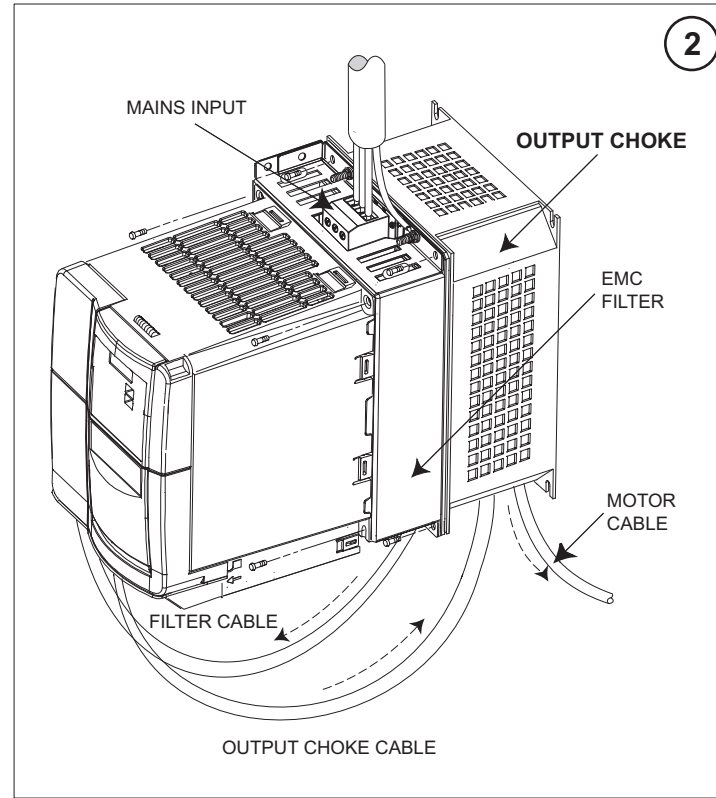
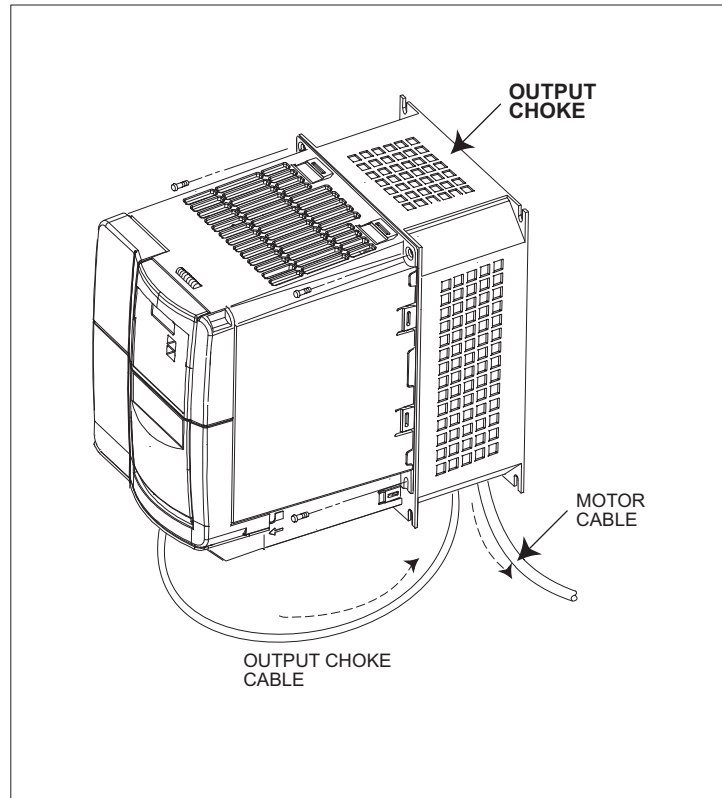

Recommended Combinations					
Inverter Frame Size	Footprint		Mounted on side		Example
	Position 1	Position 2	Line-side components (left)	Output-side components (right)	
A, B	EMC	Line	—	Output and/or Brake	—
	EMC or Line	Output or LC	—	Brake	②
C	EMC	Line	—	Output and/or Brake	—
	EMC or Line	Output	—	Brake	②

EMC = EMC filter	Output = Output choke
Line = Line commutating (Input) choke	Brake = Braking resistor
LC = LC filter	

