

CONTACTOR,AC-3 18.5 KW,400V, AC 24 V, 50 HZ 4-POLE, 2 NO + 2 NC, SIZE S2, SCREW CONNECTION



Figure similar

Product brand name	SIRIUS
Product designation	power contactor
General technical data	
Size of contactor	S2
Insulation voltage	
• rated value	690 V
Degree of pollution	3
Protection class IP	
• on the front	IP20
• of the terminal	IP00
Mechanical service life (switching cycles)	
• of contactor typical	10 000 000
• of the contactor with added electronics-compatible auxiliary switch block typical	5 000 000
• of the contactor with added auxiliary switch block typical	10 000 000

Ambient conditions

Ambient temperature	
<ul style="list-style-type: none"> • during operation • during storage 	<p style="margin: 0;">-25 ... +60 °C</p> <p style="margin: 0;">-55 ... +80 °C</p>
Main circuit	
Number of poles for main current circuit	4
Number of NO contacts for main contacts	2
Number of NC contacts for main contacts	2
Operating current	
<ul style="list-style-type: none"> • at AC-1 <ul style="list-style-type: none"> — up to 690 V at ambient temperature 40 °C rated value — up to 690 V at ambient temperature 60 °C rated value • at AC-2 at AC-3 at 400 V <ul style="list-style-type: none"> — per NO contact rated value — per NC contact rated value 	<p style="margin: 0;">60 A</p> <p style="margin: 0;">55 A</p> <p style="margin: 0;">40 A</p> <p style="margin: 0;">40 A</p>
Connectable conductor cross-section in main circuit at AC-1	
<ul style="list-style-type: none"> • at 60 °C minimum permissible • at 40 °C minimum permissible 	<p style="margin: 0;">16 mm²</p> <p style="margin: 0;">16 mm²</p>
Operating current	
<ul style="list-style-type: none"> • at 1 current path at DC-1 <ul style="list-style-type: none"> — at 24 V rated value — at 110 V rated value — at 220 V rated value — at 440 V rated value • with 2 current paths in series at DC-1 <ul style="list-style-type: none"> — at 24 V rated value — at 110 V rated value — at 220 V rated value — at 440 V rated value 	<p style="margin: 0;">50 A</p> <p style="margin: 0;">4.5 A</p> <p style="margin: 0;">1 A</p> <p style="margin: 0;">0.4 A</p> <p style="margin: 0;">50 A</p> <p style="margin: 0;">45 A</p> <p style="margin: 0;">5 A</p> <p style="margin: 0;">1 A</p>
Operating current	
<ul style="list-style-type: none"> • at 1 current path at DC-3 at DC-5 <ul style="list-style-type: none"> — at 24 V per NC contact rated value — at 24 V per NO contact rated value — at 110 V per NC contact rated value — at 110 V per NO contact rated value — at 220 V per NC contact rated value — at 220 V per NO contact rated value — at 440 V per NC contact rated value — at 440 V per NO contact rated value • with 2 current paths in series at DC-3 at DC-5 	<p style="margin: 0;">35 A</p> <p style="margin: 0;">35 A</p> <p style="margin: 0;">1.25 A</p> <p style="margin: 0;">2.5 A</p> <p style="margin: 0;">0.5 A</p> <p style="margin: 0;">1 A</p> <p style="margin: 0;">0.05 A</p> <p style="margin: 0;">0.1 A</p>

— at 24 V per NC contact rated value	50 A
— at 24 V per NO contact rated value	50 A
— at 110 V per NC contact rated value	12.5 A
— at 110 V per NO contact rated value	25 A
— at 220 V per NC contact rated value	2.5 A
— at 220 V per NO contact rated value	5 A
— at 440 V per NC contact rated value	0.135 A
— at 440 V per NO contact rated value	0.27 A
Operating power	
• at AC-1	
— at 230 V rated value	20 kW
— at 400 V rated value	36 kW
• at AC-2 at AC-3	
— at 230 V per NC contact rated value	9.5 kW
— at 230 V per NO contact rated value	9.5 kW
— at 400 V per NC contact rated value	18.5 kW
— at 400 V per NO contact rated value	18.5 kW
Power loss [W] at AC-3 at 400 V for rated value of the operating current per conductor	2.6 W
Operating frequency	
• at AC-1 maximum	1 000 1/h
Control circuit/ Control	
Type of voltage of the control supply voltage	AC
Control supply voltage at AC	
• at 50 Hz rated value	24 V
Operating range factor control supply voltage rated value of magnet coil at AC	
• at 50 Hz	0.8 ... 1.1
Apparent pick-up power of magnet coil at AC	145 V·A
• at 50 Hz	145 V·A
Inductive power factor with closing power of the coil	0.79
• at 50 Hz	0.79
Apparent holding power of magnet coil at AC	12.5 V·A
• at 50 Hz	12.5 V·A
Inductive power factor with the holding power of the coil	0.36
• at 60 Hz	0.36
Closing delay	
• at AC	4 ... 35 ms
Opening delay	
• at AC	10 ... 30 ms
Arcing time	10 ... 15 ms

Control version of the switch operating mechanism	conventional
Residual current of the electronics for control with signal <0>	
<ul style="list-style-type: none"> • at AC at 230 V maximum permissible 	0.018 A

Auxiliary circuit

Number of NC contacts	
<ul style="list-style-type: none"> • for auxiliary contacts <ul style="list-style-type: none"> — instantaneous contact 	0
Number of NO contacts	
<ul style="list-style-type: none"> • for auxiliary contacts <ul style="list-style-type: none"> — instantaneous contact 	0
Operating current at AC-12 maximum	10 A
Operating current at AC-15	
<ul style="list-style-type: none"> • at 230 V rated value • at 400 V rated value 	6 A 3 A
Operating current at DC-12	
<ul style="list-style-type: none"> • at 60 V rated value • at 110 V rated value • at 220 V rated value 	6 A 3 A 1 A
Operating current at DC-13	
<ul style="list-style-type: none"> • at 24 V rated value • at 60 V rated value • at 110 V rated value • at 220 V rated value 	10 A 2 A 1 A 0.3 A
Contact reliability of auxiliary contacts	1 faulty switching per 100 million (17 V, 1 mA)

Short-circuit protection

Design of the fuse link	
<ul style="list-style-type: none"> • for short-circuit protection of the main circuit <ul style="list-style-type: none"> — with type of coordination 1 required — with type of assignment 2 required • for short-circuit protection of the auxiliary switch required 	fuse gL/gG: 160 A fuse gL/gG: 80 A fuse gL/gG: 10 A

Installation/ mounting/ dimensions

Mounting position	with vertical mounting surface +/-180° rotatable, with vertical mounting surface +/- 30° tiltable to the front and back
Mounting type	screw and snap-on mounting onto 35 mm standard mounting rail according to DIN EN 50022
<ul style="list-style-type: none"> • Side-by-side mounting 	Yes
Height	112 mm
Width	73 mm
Depth	115 mm
Required spacing	

- for grounded parts
 - at the side

6 mm

Connections/Terminals

Type of electrical connection

- for main current circuit
- for auxiliary and control current circuit

screw-type terminals

screw-type terminals

Type of connectable conductor cross-sections

- for main contacts
 - solid
 - stranded
 - single or multi-stranded
 - finely stranded with core end processing
 - finely stranded without core end processing
- at AWG conductors for main contacts

2x (0.75 ... 16 mm²)

2x (0.75 ... 25 mm²)

2x (0,75 ... 16 mm²)

2x (0.75 ... 16 mm²)

2x (0.75 ... 16 mm²)

2x (18 ... 2)

Type of connectable conductor cross-sections

- for auxiliary contacts
 - solid
 - single or multi-stranded
 - finely stranded with core end processing
- at AWG conductors for auxiliary contacts

2x (0.5 ... 1.5 mm²), 2x (0.75 ... 2.5 mm²), max. 2x (0.75 ... 4 mm²)

2x (0,5 ... 1,5 mm²), 2x (0,75 ... 2,5 mm²), max. 2x (0,75 ... 4 mm²)

2x (0.5 ... 1.5 mm²), 2x (0.75 ... 2.5 mm²)

2x (20 ... 16), 2x (18 ... 14), 1x 12

Safety related data

Failure rate [FIT]

- with low demand rate acc. to SN 31920

100 FIT

Certificates/approvals

General Product Approval	Functional Safety/Safety of Machinery	Declaration of Conformity	Test Certificates
--------------------------	---------------------------------------	---------------------------	-------------------



[Type Examination Certificate](#)



[Special Test Certificate](#)

Marine / Shipping



other

[Environmental Confirmations](#)

[Confirmation](#)

[Miscellaneous](#)

Further information

Information- and Downloadcenter (Catalogs, Brochures,...)

<http://www.siemens.com/industrial-controls/catalogs>

Industry Mall (Online ordering system)

<https://mall.industry.siemens.com/mall/en/en/Catalog/product?mlfb=3RT1535-1AB00>

Cax online generator

<http://support.automation.siemens.com/WW/CAXorder/default.aspx?lang=en&mlfb=3RT1535-1AB00>

Service&Support (Manuals, Certificates, Characteristics, FAQs,...)

<https://support.industry.siemens.com/cs/ww/en/ps/3RT1535-1AB00>

Image database (product images, 2D dimension drawings, 3D models, device circuit diagrams, EPLAN macros, ...)

http://www.automation.siemens.com/bilddb/cax_de.aspx?mlfb=3RT1535-1AB00&lang=en

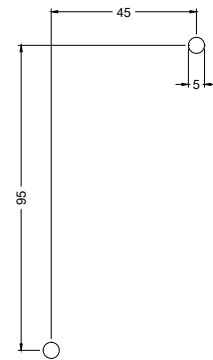
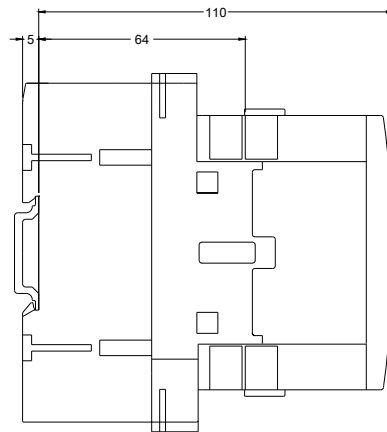
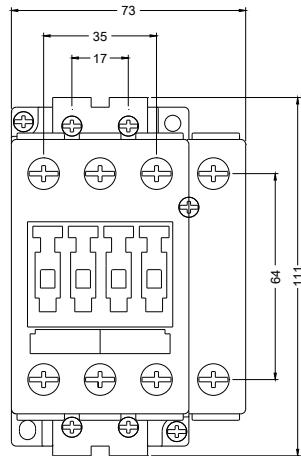

SIEMENS	3RT1336_00001866_000_ALL	
	Schütz 4pol S2	
Format / Size: DIN A3	Maßstab / Scale: 1:1	

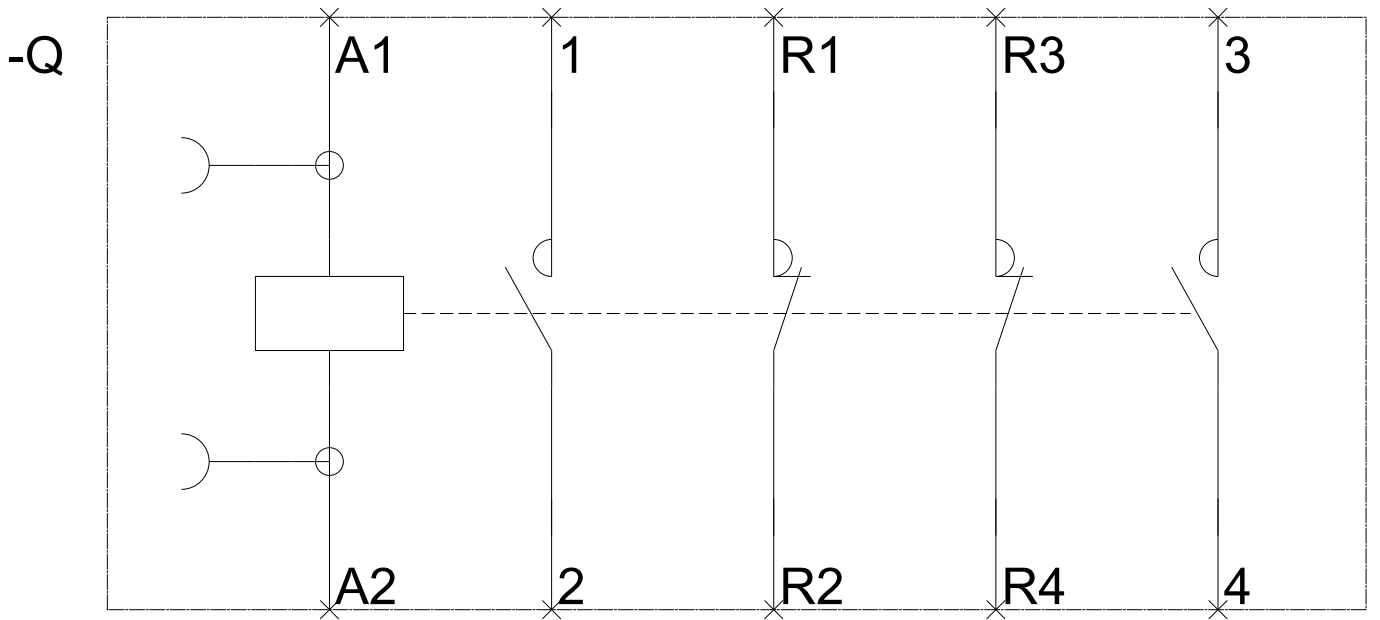

last modified:

08/20/2017