

DS1-X FOR ET 200S ELECTROMECHANICS LINE
STARTER EXPANDABLE ADJUSTABLE RANGE
0.14...0.20A AC-3, TO 0.06 KW/400V FOR BRAKE
CONTROL MODULE



| General technical data: | | |
|--------------------------------------|--|-----------------------|
| product brandname | | Sirius |
| Product designation | | motor starter ET 200S |
| Design of the product | | direct starter |
| Product function | | |
| • Bus communication | | Yes |
| • direct start | | Yes |
| • reverse starting | | No |
| • on-site operation | | Yes |
| • Short circuit protection | | Yes |
| Design of the switching contact | | electromechanical |
| Product component Motor brake output | | Yes |
| Trip class | | CLASS 10 |
| Type of assignment | | 2 |
| Product feature | | |
| • brake control with 230 V AC | | No |
| • brake control with 24 V DC | | No |
| • brake control with 180 V DC | | No |
| • brake control with 500 V DC | | No |

| | | |
|---|----|------------------------------|
| Product extension braking module for brake control | | Yes |
| Surge voltage resistance rated value | kV | 6 |
| Insulation voltage rated value | V | 500 |
| Power loss [W] typical | W | 9 |
| maximum permissible voltage for safe isolation between main and auxiliary circuit | V | 400 |
| Equipment marking acc. to DIN EN 61346-2 | | Q |
| Equipment marking acc. to DIN 40719 extended according to IEC 204-2 acc. to IEC 750 | | A |
| Mounting type | | pluggable on terminal module |
| Depth | mm | 120 |
| Height | mm | 265 |
| Width | mm | 45 |

Main circuit:

| | | |
|---|----|------------------|
| Operating voltage rated value | V | 200 ... 400 |
| Adjustable pick-up value current of the current-dependent overload release | A | 0.14 ... 0.2 |
| Operating power | | |
| • at AC-3 at 400 V rated value | kW | 0.06 |
| • for three-phase motors at 400 V at 50 Hz minimum | kW | 0.06 |
| • for three-phase motors at 400 V at 50 Hz maximum | kW | 0.06 |
| Maximum short-circuit current breaking capacity (I _{cu}) at 400 V rated value | kA | 50 |
| Design of short-circuit protection | | circuit-breakers |
| Number of poles for main current circuit | | 3 |
| Type of the motor protection | | bimetal |
| Mechanical service life (switching cycles) of the main contacts typical | | 100 000 |

Control circuit/ Control:

| | | |
|---|---|---------------|
| Type of voltage of the control supply voltage | | DC |
| Control supply voltage 1 at DC | V | 24 ... 24 |
| Control supply voltage 1 at DC rated value | V | 20.4 ... 28.8 |

Supply voltage:

| | | |
|---------------------------------------|---|---------------|
| Type of voltage of the supply voltage | | DC |
| Supply voltage 1 at DC | V | 24 ... 24 |
| Supply voltage 1 at DC rated value | V | 20.4 ... 28.8 |

Ambient conditions:

| | | |
|---------------------|----|----------|
| Protection class IP | | IP20 |
| Ambient temperature | | |
| • during operation | °C | 0 ... 60 |

| | | |
|--|----|---|
| • during storage | °C | -40 ... +70 |
| • during transport | °C | -40 ... +70 |
| Relative humidity during operation | % | 5 ... 95 |
| Vibration resistance | | 2g |
| Shock resistance | | 5g / 11 ms |
| Degree of pollution | | 3 at 400 V, 2 at 500 V according to IEC60664 (IEC61131) |
| Installation altitude at height above sea level maximum | m | 2 000 |
| Mounting position | | vertical, horizontal |

Communication/ Protocol:

| | | |
|--|--|-------------------|
| Protocol is supported | | |
| • PROFIBUS DP protocol | | Yes |
| • PROFINET protocol | | Yes |
| • AS-interface protocol | | No |
| Design of the interface PROFINET protocol | | Yes |
| Type of electrical connection | | |
| • of the communication interface | | via backplane bus |
| • for communication transmission | | via backplane bus |

Connections/ Terminals:

| | | |
|---|--|----------------------|
| Number of digital inputs | | 0 |
| Number of sockets | | |
| • for digital input signals | | 0 |
| • for digital output signals | | 0 |
| Product function | | |
| • digital inputs parameterizable | | No |
| • digital outputs parameterizable | | No |
| Type of electrical connection | | |
| • 1 for digital input signals | | using control module |
| • 2 for digital input signals | | using control module |
| Type of electrical connection | | |
| • at the manufacturer-specific device interface | | plug |
| • for main energy infeed | | screw-type terminals |
| • for load-side outgoing feeder | | Screw-type terminals |
| • for main energy transmission | | via energy bus |
| • for supply voltage line-side | | via backplane bus |
| • for supply voltage transmission | | via backplane bus |
| • for main current circuit | | screw-type terminals |

Electromagnetic compatibility:

| | | |
|---|--|---|
| EMI immunity acc. to IEC 60947-1 | | corresponds to degree of severity 3, ambience A (industrial sector) |
|---|--|---|

| | | |
|---|--|--|
| Conducted interference due to burst acc. to IEC 61000-4-4 | | 2 kV on voltage supply, inputs and outputs |
| Conducted interference due to conductor-earth surge acc. to IEC 61000-4-5 | | 2 kV (U > 24 V DC) |
| Conducted interference due to conductor-conductor surge acc. to IEC 61000-4-5 | | 1 kV (U > 24 V DC) |
| Field-bound parasitic coupling acc. to IEC 61000-4-3 | | 80 MHz ... 1 GHz 10 V/m, 1.4 GHz ... 2 Hz 3 V/m, 2 GHz ... 2.7 GHz 1 V/m |
| EMC emitted interference acc. to IEC 60947-1 | | CISPR11, ambience A (industrial sector) |

Safety related data:

| | |
|-------------------------------------|-------------|
| Protection against electrical shock | finger-safe |
|-------------------------------------|-------------|

Certificates/ approvals:

| | |
|--------------------------|--------------------------------|
| General Product Approval | For use in hazardous locations |
|--------------------------|--------------------------------|



CCC



CSA



UL



ATEX



IECEX

| | | |
|---------------------------|-------------------|-------|
| Declaration of Conformity | Test Certificates | other |
|---------------------------|-------------------|-------|



EG-Konf.

[Type Test Certificates/Test Report](#)

[Environmental Confirmations](#)

[Confirmation](#)

Further information

Information- and Downloadcenter (Catalogs, Brochures,...)

<http://www.siemens.com/industrial-controls/catalogs>

Industry Mall (Online ordering system)

<http://www.siemens.com/industrymall>

Cax online generator

<http://support.automation.siemens.com/WW/CAXorder/default.aspx?lang=en&mlfb=3RK1301-0BB00-0AA2>

Service&Support (Manuals, Certificates, Characteristics, FAQs,...)

<https://support.industry.siemens.com/cs/ww/en/ps/3RK1301-0BB00-0AA2>

Image database (product images, 2D dimension drawings, 3D models, device circuit diagrams, EPLAN macros, ...)

http://www.automation.siemens.com/bilddb/cax_de.aspx?mlfb=3RK1301-0BB00-0AA2&lang=en

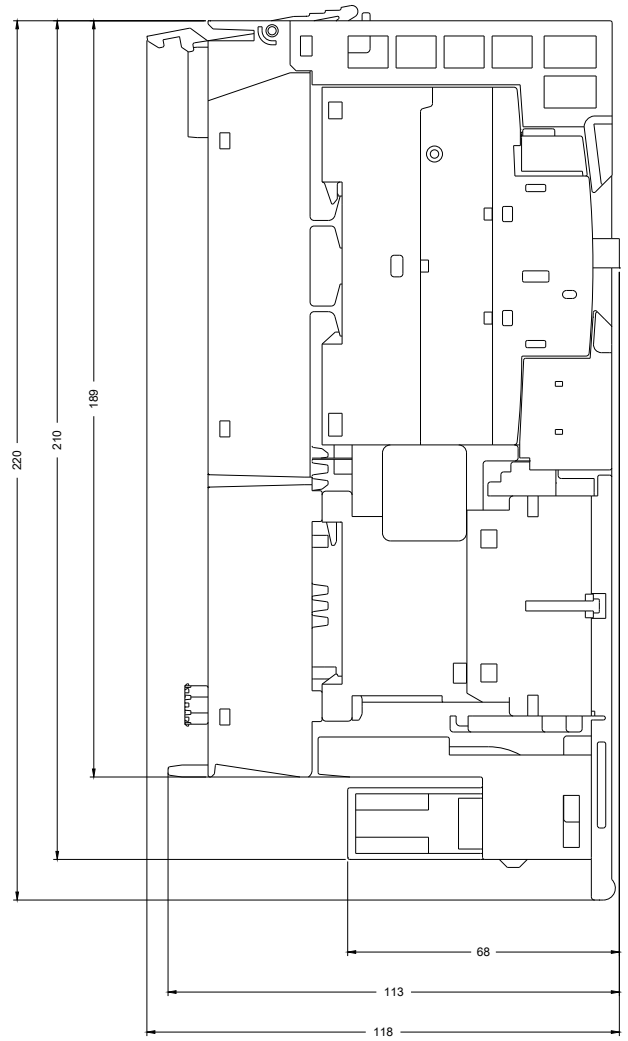
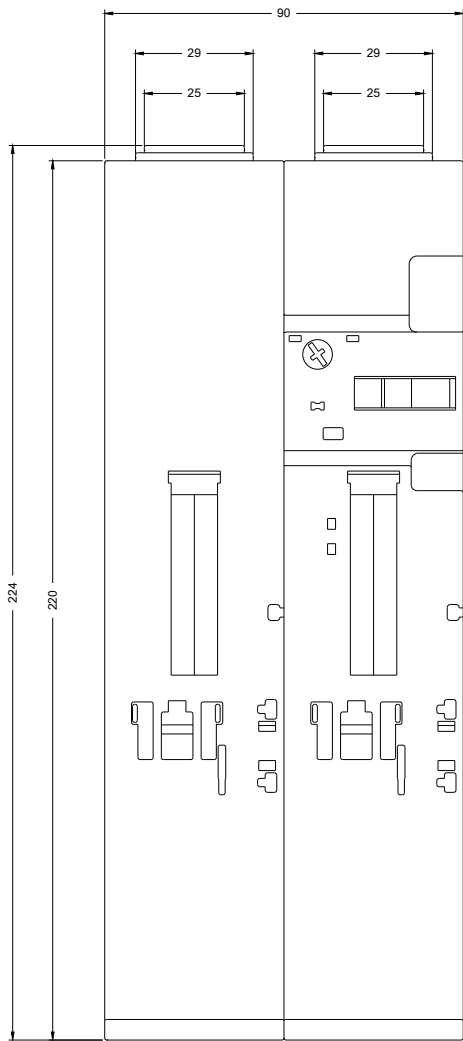

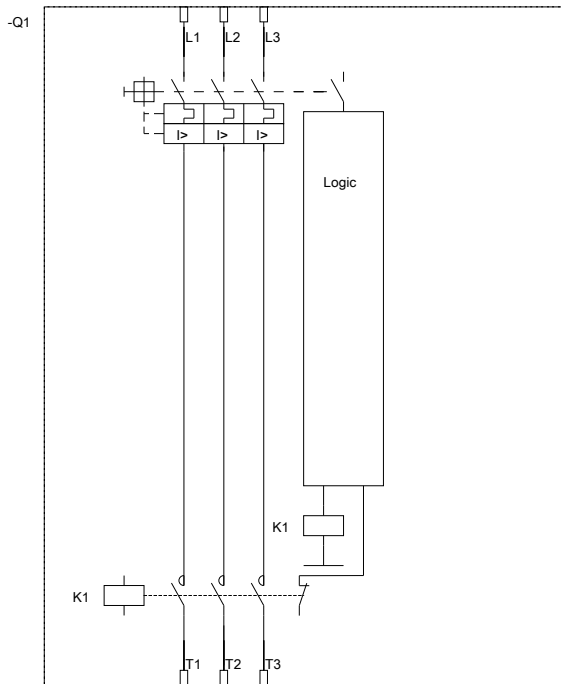

| | |
|--------|-------------------------|
| DI 0.0 | Bereit |
| DI 0.1 | Schütz ein |
| DI 0.2 | Leistungsschalter ausg. |
| DO 0.0 | Motor ein |
| DO 0.2 | Bremse |

| | |
|--------|-------------------------|
| DI 0.0 | Ready |
| DI 0.1 | Contactor on |
| DI 0.2 | Circuit breaker tripped |
| DO 0.0 | Motor on |
| DO 0.2 | Brake |

last modified:

08/11/2017