



CONTACTOR RELAY, 2NO+2NC, DC 24 V,
CAGE CLAMP CONNECTION, SIZE S00

General details:

| | | |
|--|----|--|
| product brand name | | SIRIUS |
| product designation | | contactor relay |
| Size of the contactor | | S00 |
| Protection class IP / on the front | | IP20 |
| Degree of pollution | | 3 |
| Insulation voltage / with degree of pollution 3 / rated value | V | 690 |
| Installation altitude / at a height over sea level / maximum | m | 2,000 |
| Ambient temperature | | |
| • during transport | °C | -55 ... +80 |
| • during storage | °C | -55 ... +80 |
| • during operating | °C | -25 ... +60 |
| Contact reliability | | one incorrect switching operation of 100 million switching operations (17 V, 1 mA) |
| Resistance against shock | | 10g / 5 ms and 5g / 10 ms |
| Impulse voltage resistance / rated value | kV | 6 |
| Item designation | | |
| • according to DIN EN 61346-2 | | K |
| • according to DIN 40719 extendable after IEC 204-2 / according to IEC 750 | | K |
| Mechanical operating cycles as operating time | | |

- of the contactor / typical
- of the contactor with added auxiliary switch block / typical
- of the contactor with added electronics-compatible auxiliary switch block / typical

30,000,000
10,000,000
5,000,000

Control circuit:

Type of voltage / of the controlled supply voltage

DC

Control supply voltage / 1

- for DC / rated value

V

24

operating range factor control supply voltage rated value / of the magnet coil

- for DC

0.8 ... 1.1

Pull-in power / of the solenoid / for DC

W

3.2

Holding power / of the solenoid / for DC

W

3.2

Auxiliary circuit:

Product extension / auxiliary switch

Yes

Identification number and letter for switching elements

22 E

Contact reliability / of the auxiliary contacts

1 faulty switching per 100 million (17 V, 1 mA)

Number of NC contacts / for auxiliary contacts

2

- delayed switching

0

- instantaneous switching

2

- asynchronous switching

0

- lagging switching

0

Number of NO contacts / for auxiliary contacts

2

- instantaneous switching

2

- delayed switching

0

- asynchronous switching

0

- leading switching

0

Number of changeover contacts

- for auxiliary contacts

0

- of the auxiliary contacts / instantaneous switching

0

Operating current / of the auxiliary contacts

- at AC-12 / maximum

A

10

- at AC-15

- at 230 V

A

6

- at 400 V

A

3

- at 500 V

A

2

- at 690 V

A

1

- with 1 current path

- at DC-12

- at 24 V
- at 110 V
- at 220 V
- at DC-13
 - at 24 V
 - at 110 V
 - at 220 V

| | |
|---|------|
| A | 10 |
| A | 3 |
| A | 1 |
| A | 10 |
| A | 1 |
| A | 0.27 |

Short-circuit:

Design of the fuse link / for short-circuit protection of the auxiliary switch / required

fuse gL/gG: 10 A

Installation/mounting/dimensions:

mounting position

+/-180° rotation possible on vertical mounting surface;
can be tilted forward and backward by +/- 22.5° on vertical mounting surface

Type of mounting

screw and snap-on mounting

Width

mm 45

Height

mm 60

Depth

mm 73

Distance, to be maintained, to the ranks assembly / sideways

mm 0

Connections:

Design of the electrical connection / for auxiliary and control current circuit

Cage Clamp terminals

Type of the connectable conductor cross-section

- for auxiliary contacts
 - solid
 - finely stranded
 - with conductor end processing
 - without conductor final cutting
- for AWG conductors / for auxiliary contacts

2x (0.25 ... 2.5 mm²)

2x (0.25 ... 1.5 mm²)

2x (0.25 ... 2.5 mm²)

2x (24 ... 14)

Certificates/approvals:

Verification of suitability

CSA / UL / CCC / GL / LRS / BV / DNV / RMRS / RINA

| General Product Approval | Functional Safety / Safety of Machinery | Declaration of Conformity |
|--------------------------|---|---------------------------|
|--------------------------|---|---------------------------|



CCC



CSA



GOST



UL

[Type Examination](#)



EG-Konf.

Test Certificates

[Special Test Certificate](#)

Shipping Approval



ABS



BUREAU
VERITAS



DNV



GL



LRS



PRS

Shipping Approval

other



RINA



RMRS

[Confirmation](#)

[other](#)

Safety:

Proportion of dangerous failures

- with high demand rate / according to SN 31920
- with low demand rate / according to SN 31920

%

75

%

40

T1 value / for proof test interval or service life / according to IEC 61508

a

20

Protection against electrical shock

finger-safe

B10 value / with high demand rate / according to SN 31920

1,000,000

Further information:

Information- and Downloadcenter (Catalogs, Brochures,...)

<http://www.siemens.com/industrial-controls/catalogs>

Industry Mall (Online ordering system)

<http://www.siemens.com/industrial-controls/mall>

CAX-Online-Generator

<http://www.siemens.com/cax>

Service&Support (Manuals, Certificates, Characteristics, FAQs,...)

<http://support.automation.siemens.com/WW/view/en/3RH1122-2BB40/all>

Image database (product images, 2D dimension drawings, 3D models, device circuit diagrams, ...)

http://www.automation.siemens.com/bilddb/cax_en.aspx?mlfb=3RH1122-2BB40

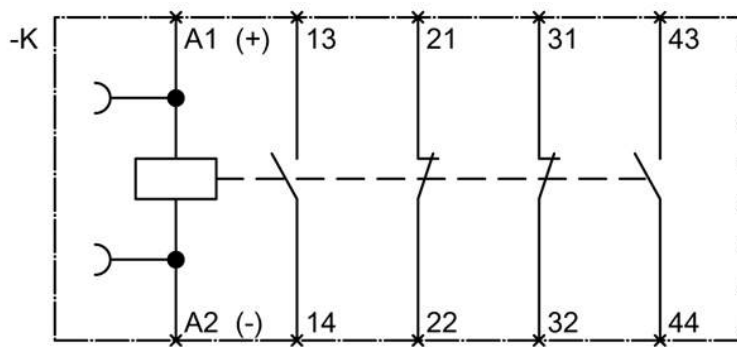
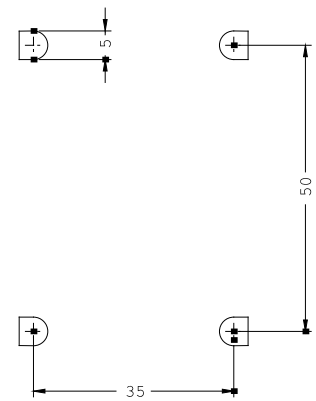
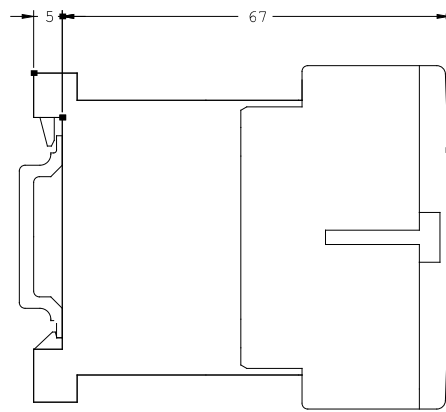
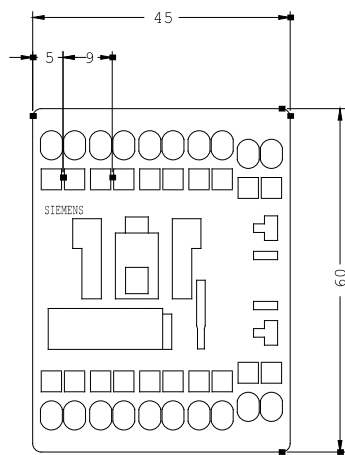

last change:

Jul 17, 2012